

PREPARED ON BEHALF OF DAVID PORTER & CYNTHIA BOYD FOR THE PURPOSE OF
PURCHASING THE PROPERTY FROM ERNEST FREDERICK WILLIAM KELLY & MARY BLANCHE KELLY

PROPOSED ARRANGEMENT
2020 DMP TUNIS COURT
(16.45 metres wide)

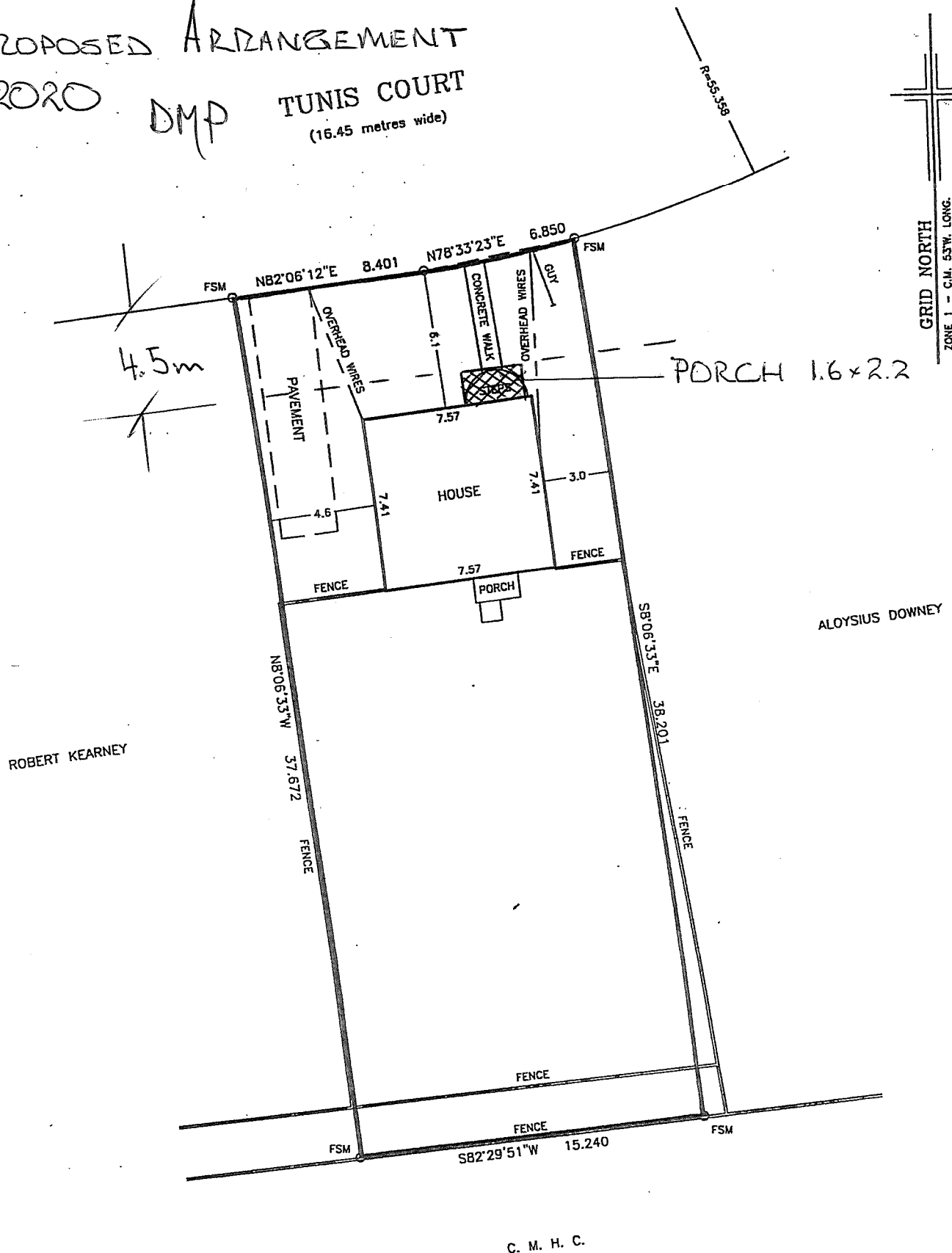

FSM - FOUND SURVEY MARKER

COPYRIGHT NOTICE

MAXWELL SULLIVAN, NEWFOUNDLAND LAND SURVEYOR, 1999

UNAUTHORIZED USE, ALTERATION OR REPRODUCTION OF
THIS SURVEY DOCUMENT IS PROHIBITED BY LAW AS
OUTLINED IN THE COPYRIGHT ACT. THE AUTHORIZING
SURVEYOR HEREBY AUTHORIZES THE REPRODUCTION
OF THIS SURVEY DOCUMENT FOR THE HEREIN DEFINED
INTENDED PURPOSE ONLY. FURTHER USE, BEYOND THAT
FOR WHICH THIS SURVEY DOCUMENT WAS PREPARED, IS
STRICTLY PROHIBITED.

NOTES:

REFERENCE SURVEY BY MAX SULLIVAN SURVEYS LTD.
MAXWELL SULLIVAN, N.L.S. - DATED 1999 02 18

THIS REPORT CONSISTS OF TWO PAGES, EACH FORMING AN
INTEGRAL PART AND BECOMES INVALID IF SEPARATED.

THE SURVEYOR CERTIFIES THE INFORMATION CONTAINED
WITHIN THIS REPORT TO BE CURRENT AS OF 1999 02 18.

DISTANCES SHOWN FROM BOUNDARIES TO STRUCTURES
ARE PERPENDICULAR TO THE BOUNDARIES.

THE INFORMATION SHOWN ON THIS PLAN SHOULD NOT
BE USED FOR ERECTING FENCES.

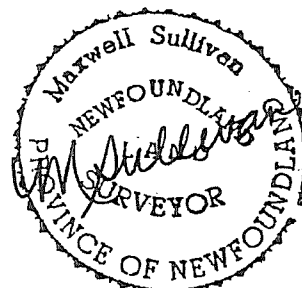

SCALE 1:250 1999 02 18