

**LEGEND**

- PROPERTY BOUNDARY
- LAND TO BE REZONED
- (A2) APARTMENT 2
- (AG) AGRICULTURE
- (CDA8) COMPREHENSIVE DEV. AREA
- (CN) COMMERCIAL NEIGHBOURHOOD
- (CR) COMMERCIAL REGIONAL
- (INST) INSTITUTIONAL
- (O) OPEN SPACE
- (OR) OPEN SPACE RESERVE
- (R1) RESIDENTIAL 1
- (R2) RESIDENTIAL 2
- (RUR) RURAL

REZONING TABLE AREAS 5 & 6	PARCEL No. 1 (m <sup>2</sup> )	PARCEL No. 2 (m <sup>2</sup> )	PARCEL No. 3 (m <sup>2</sup> )	TOTAL AREA (m <sup>2</sup> )
OPEN SPACE	38,428.67	47,721.78	5,602.57	91,753.02
RURAL	1,785.42	-	-	1,785.42
TOTAL LAND TO BE REZONED PER AREA	40,214.09	47,721.78	5,602.57	93,538.44

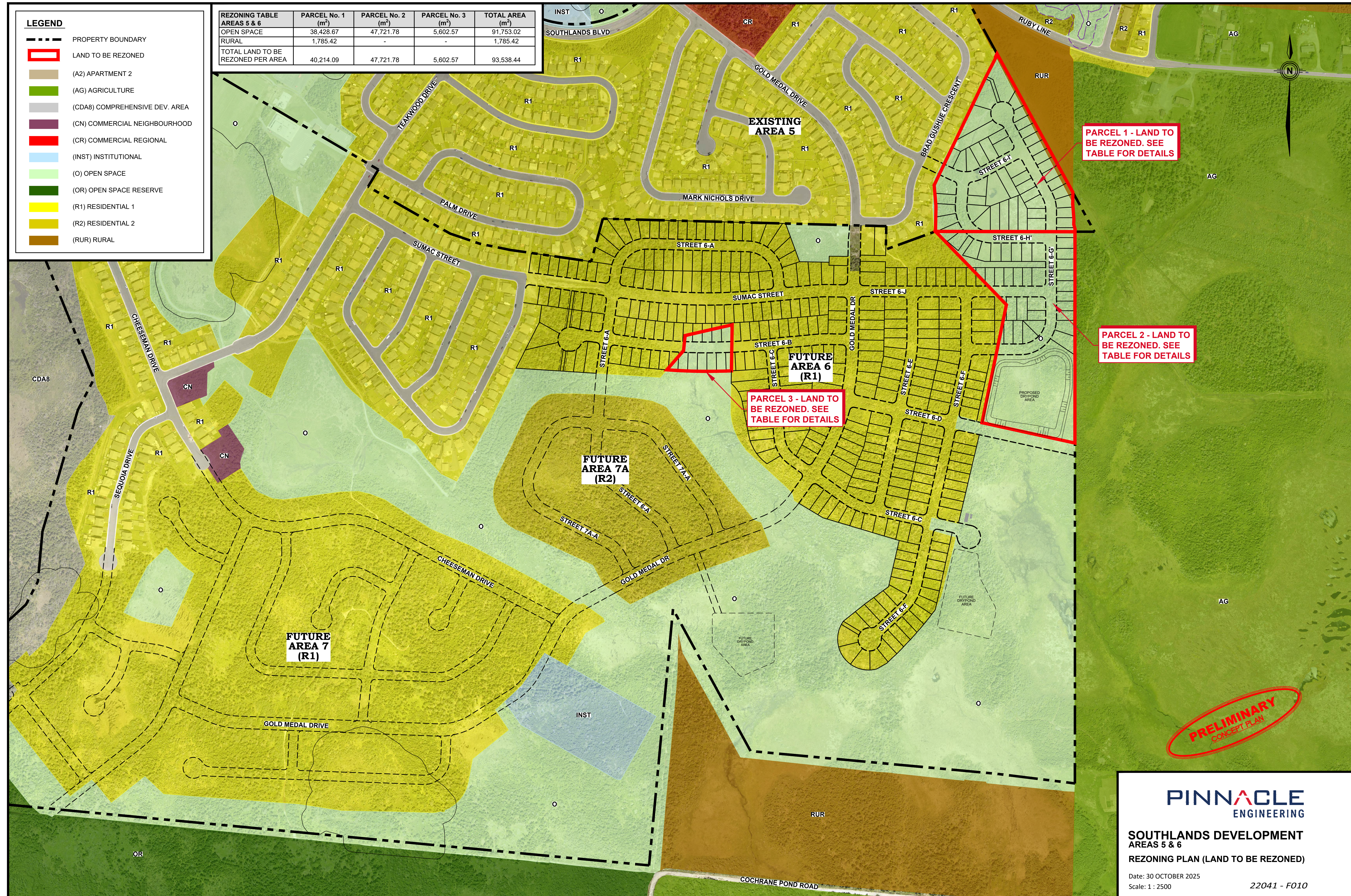

PRELIMINARY  
CONCEPT PLAN

**PINNACLE**  
ENGINEERING

**SOUTHLANDS DEVELOPMENT  
AREAS 5 & 6  
REZONING PLAN (LAND TO BE REZONED)**

Date: 30 OCTOBER 2025  
Scale: 1 : 2500

22041 - F010